



FRONT ELEVATION - A VERSION

STERLING



*THE DRAWING(S) ON THIS PAGE ARE A GRAPHICAL REPRESENTATION ONLY. PLEASE CONSULT YOUR AGENT FOR SPECIFIC INFORMATION REGARDING THIS FLOOR PLAN. THE DESIGN OF THE FLOOR PLAN REPRESENTED IS SUBJECT TO CHANGE WITHOUT NOTICE.

SQUARE FOOTAGE:	
FIRST FLOOR:	2,124 SQ. FT.
SECOND FLOOR:	2,224 SQ. FT.
THIRD FLOOR:	943 SQ. FT.
TOTAL:	5,291 SQ. FT.



FRONT ELEVATION - F VERSION

STERLING

JEFF LINDSEY COMMUNITIES
Live your dream.

*THE DRAWING(S) ON THIS PAGE ARE A GRAPHICAL REPRESENTATION ONLY. PLEASE CONSULT YOUR AGENT FOR SPECIFIC INFORMATION REGARDING THIS FLOOR PLAN. THE DESIGN OF THE FLOOR PLAN REPRESENTED IS SUBJECT TO CHANGE WITHOUT NOTICE.

SQUARE FOOTAGE:	
FIRST FLOOR:	2,124 SQ. FT.
SECOND FLOOR:	2,224 SQ. FT.
THIRD FLOOR:	943 SQ. FT.
TOTAL:	5,291 SQ. FT.

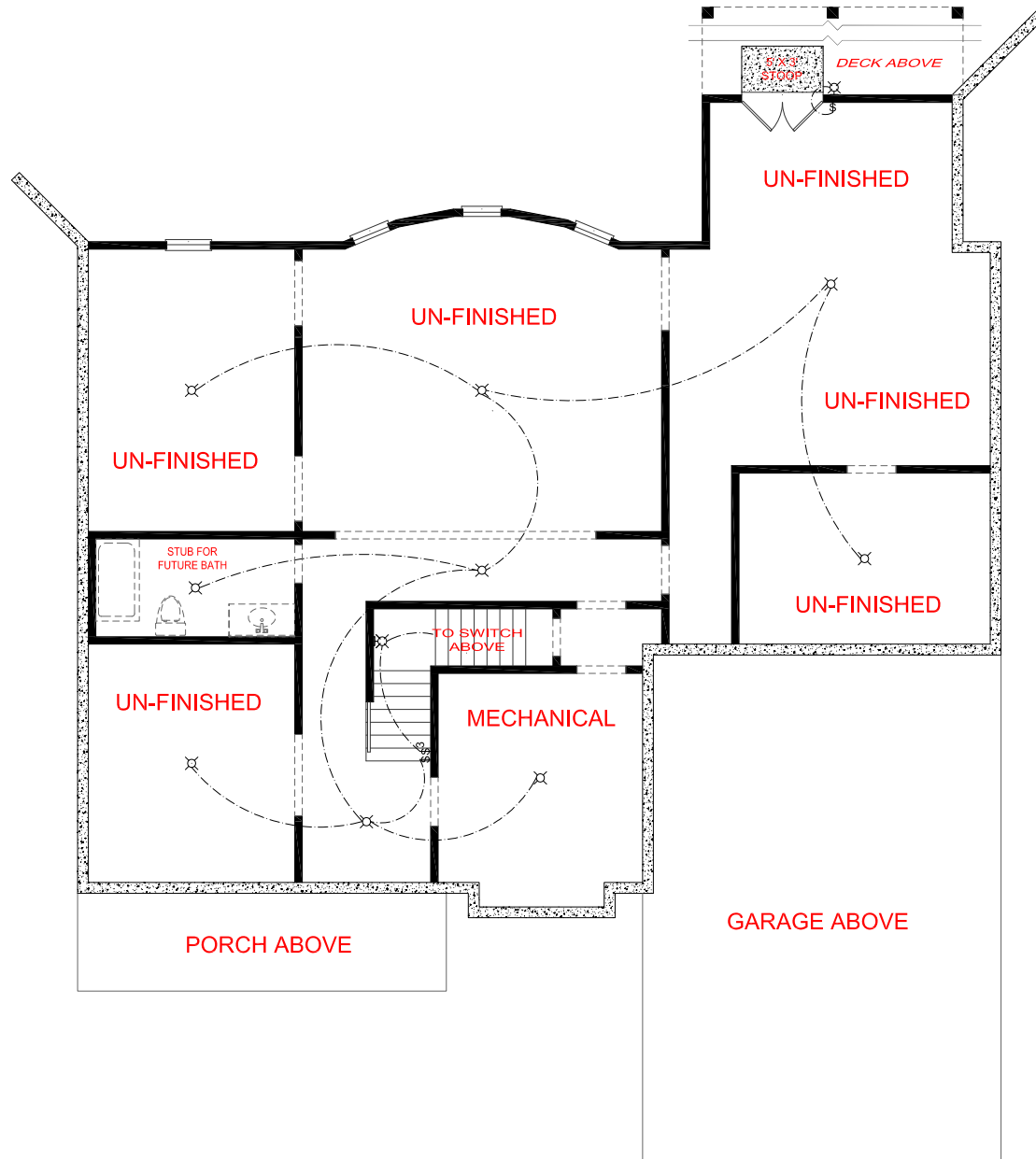

OPTION BASEMENT

ELECTRICAL LEGEND	
	CEILING LIGHT FIXTURE
	WALL LIGHT FIXTURE
	7" LED DISK
	10" LED DISK
	CEILING FAN
	FLOOD LIGHT FIXTURE
	DUPLEX FLOOR OUTLET
	TELEPHONE
	NETWORK/CABLE
	SWITCH
	3-WAY SWITCH
	4-WAY SWITCH
	MOTION SENSOR SWITCH
	EXHAUST FAN
	EXHAUST FAN/LIGHT
	SCONCE LIGHT FIXTURE

SQUARE FOOTAGE:	
FIRST FLOOR:	2,124 SQ. FT.
SECOND FLOOR:	2,224 SQ. FT.
THIRD FLOOR:	943 SQ. FT.
TOTAL:	5,291 SQ. FT.

STERLING

JEFF LINDSEY COMMUNITIES
Live your dream.

*THE DRAWING(S) ON THIS PAGE ARE A GRAPHICAL REPRESENTATION ONLY. PLEASE CONSULT YOUR AGENT FOR SPECIFIC INFORMATION REGARDING THIS FLOOR PLAN. THE DESIGN OF THE FLOOR PLAN REPRESENTED IS SUBJECT TO CHANGE WITHOUT NOTICE.

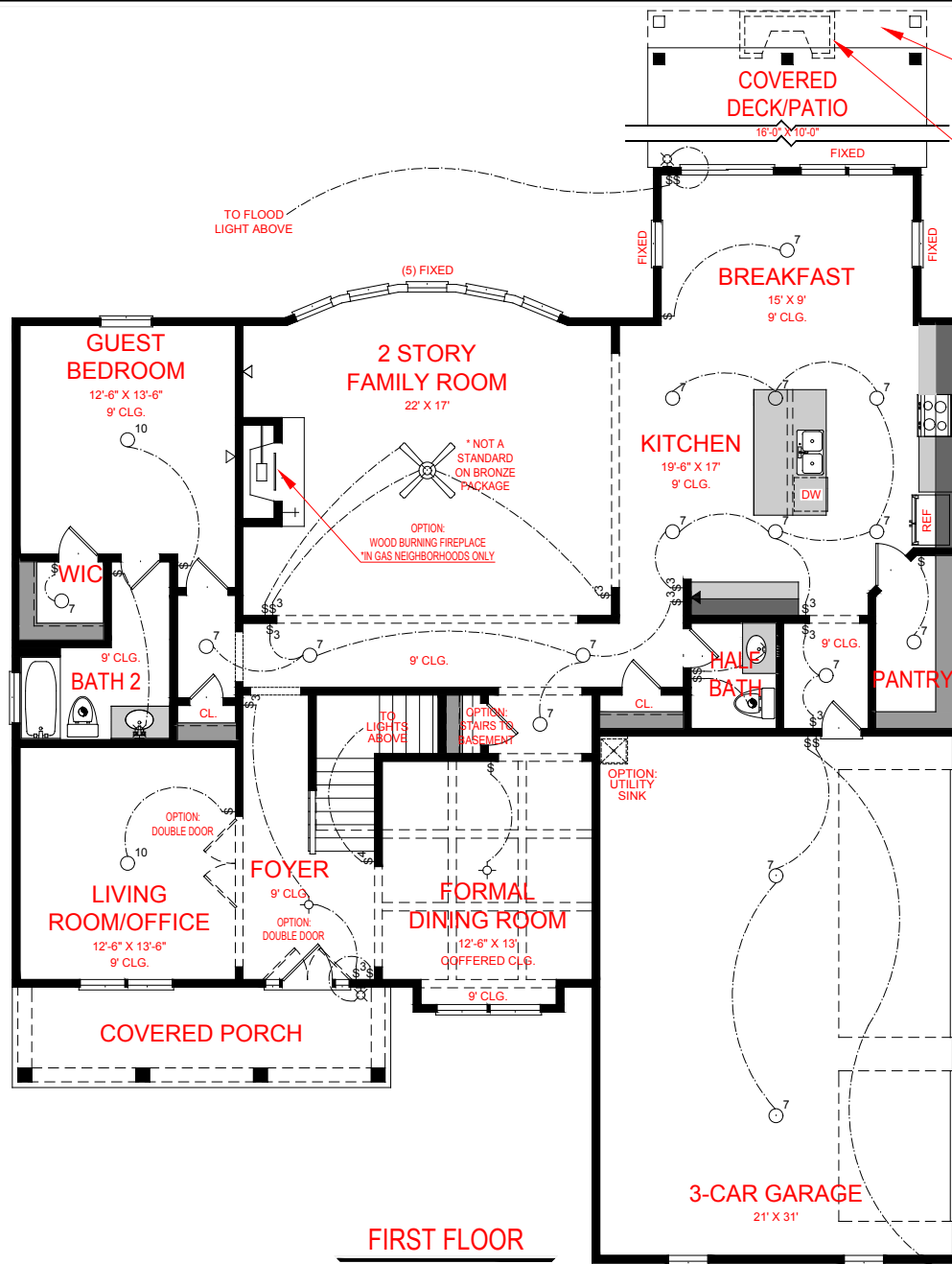

OPTION:
EXPANDED COVERED PATIO/DECK
16'-0" x 6'-0"

OPTION:
FIREPLACE
*LOCATION CENTERED ON REAR FOR
STANDARD AND EXPANDED PATIO/DECK
VERSIONS AND CAN NOT CHANGE
*FIREPLACE SLIDES INSIDE FOOTPRINT
OF DECK ON DECK VERSIONS

TO FLOOD
LIGHT ABOVE

(5) FIXED

* NOT A
STANDARD
ON BRONZE
PACKAGE

OPTION:
WOOD BURNING FIREPLACE
*IN GAS NEIGHBORHOODS ONLY

TO
LIGHTS
ABOVE

OPTION:
STAIRS TO
BASEMENT

OPTION:
UTILITY
SINK

- ELECTRICAL LEGEND**
- CEILING LIGHT FIXTURE
 - WALL LIGHT FIXTURE
 - 7" LED DISK
 - 10" LED DISK
 - CEILING FAN
 - FLOOD LIGHT FIXTURE
 - DUPLEX FLOOR OUTLET
 - TELEPHONE
 - NETWORK/CABLE
 - SWITCH
 - 3-WAY SWITCH
 - 4-WAY SWITCH
 - MOTION SENSOR SWITCH
 - EXHAUST FAN
 - EXHAUST FAN/LIGHT
 - SCONCE LIGHT FIXTURE

FIRST FLOOR

STERLING

JEFF LINDSEY COMMUNITIES
Live your dream.

*THE DRAWING(S) ON THIS PAGE ARE A GRAPHICAL REPRESENTATION ONLY. PLEASE CONSULT YOUR AGENT FOR SPECIFIC INFORMATION REGARDING THIS FLOOR PLAN. THE DESIGN OF THE FLOOR PLAN REPRESENTED IS SUBJECT TO CHANGE WITHOUT NOTICE.





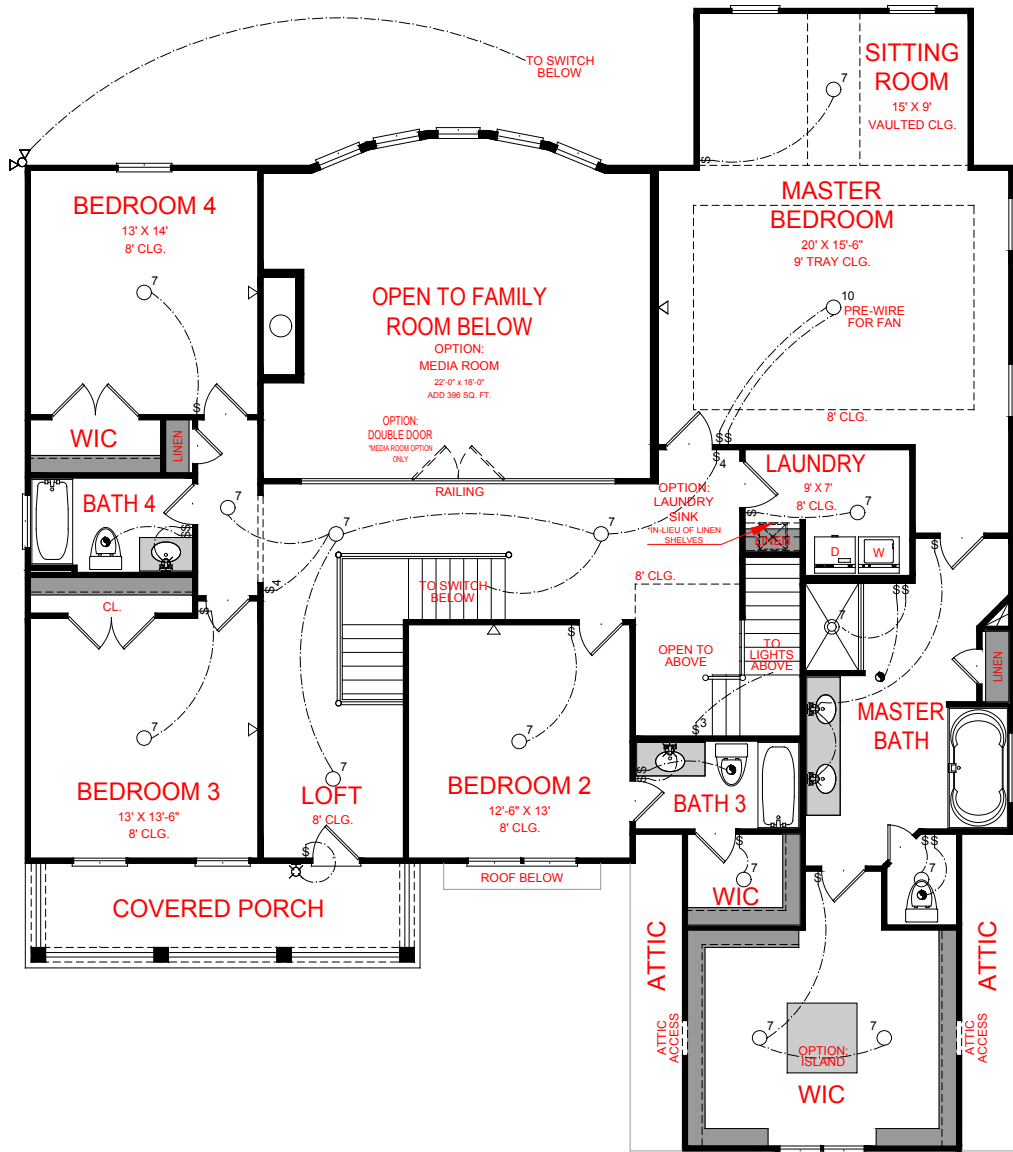







SQUARE FOOTAGE:

FIRST FLOOR:	2,124 SQ. FT.
SECOND FLOOR:	2,224 SQ. FT.
THIRD FLOOR:	943 SQ. FT.
TOTAL:	5,291 SQ. FT.

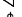
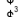
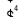
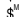

SECOND FLOOR

ELECTRICAL LEGEND

-  CEILING LIGHT FIXTURE
-  WALL LIGHT FIXTURE
-  7" LED DISK
-  10" LED DISK
-  CEILING FAN
-  FLOOD LIGHT FIXTURE
-  DUPLEX FLOOR OUTLET
-  TELEPHONE
-  NETWORK/CABLE
-  SWITCH
-  3-WAY SWITCH
-  4-WAY SWITCH
-  MOTION SENSOR SWITCH
-  EXHAUST FAN
-  EXHAUST FAN/LIGHT
-  SCONCE LIGHT FIXTURE

SQUARE FOOTAGE:

FIRST FLOOR:	2,124 SQ. FT.
SECOND FLOOR:	2,224 SQ. FT.
THIRD FLOOR:	943 SQ. FT.
TOTAL:	5,291 SQ. FT.

STERLING

JEFF LINDSEY COMMUNITIES
Live your dream.



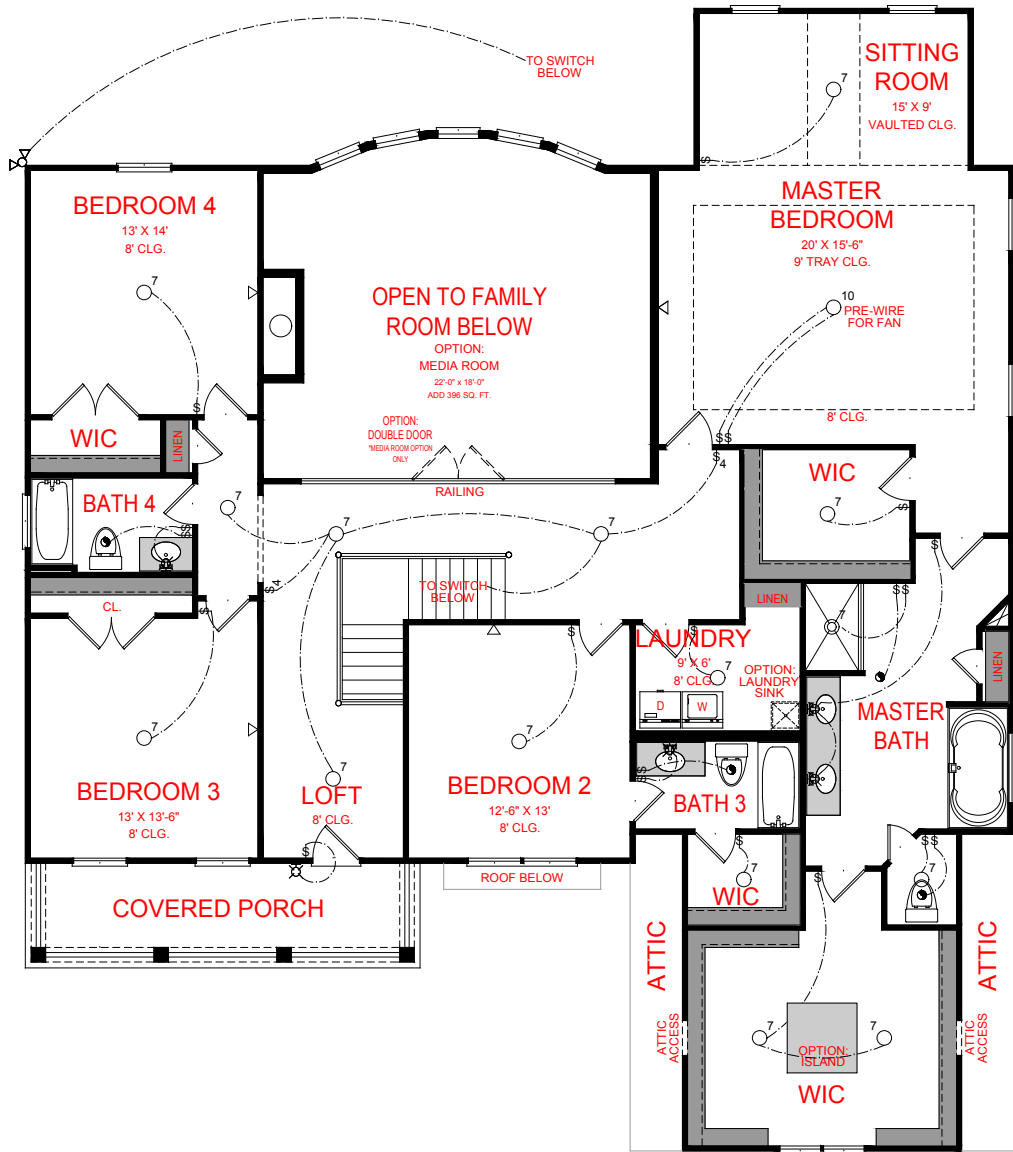







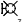

*THE DRAWING(S) ON THIS PAGE ARE A GRAPHICAL REPRESENTATION ONLY. PLEASE CONSULT YOUR AGENT FOR SPECIFIC INFORMATION REGARDING THIS FLOOR PLAN. THE DESIGN OF THE FLOOR PLAN REPRESENTED IS SUBJECT TO CHANGE WITHOUT NOTICE.



SECOND FLOOR

*ALTERNATE LAYOUT FOR TWO STORY VERSION ONLY

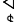
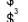
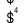
ELECTRICAL LEGEND

-  CEILING LIGHT FIXTURE
-  WALL LIGHT FIXTURE
-  7" LED DISK
-  10" LED DISK
-  CEILING FAN
-  FLOOD LIGHT FIXTURE
-  DUPLEX FLOOR OUTLET
-  TELEPHONE
-  NETWORK/CABLE
-  SWITCH
-  3-WAY SWITCH
-  4-WAY SWITCH
-  MOTION SENSOR SWITCH
-  EXHAUST FAN
-  EXHAUST FANLIGHT
-  SCONCE LIGHT FIXTURE

SQUARE FOOTAGE:

FIRST FLOOR:	2,124 SQ. FT.
SECOND FLOOR:	2,224 SQ. FT.
THIRD FLOOR:	943 SQ. FT.
TOTAL:	5,291 SQ. FT.

STERLING

JEFF LINDSEY COMMUNITIES
Live your dream.

*THE DRAWING(S) ON THIS PAGE ARE A GRAPHICAL REPRESENTATION ONLY. PLEASE CONSULT YOUR AGENT FOR SPECIFIC INFORMATION REGARDING THIS FLOOR PLAN. THE DESIGN OF THE FLOOR PLAN REPRESENTED IS SUBJECT TO CHANGE WITHOUT NOTICE.

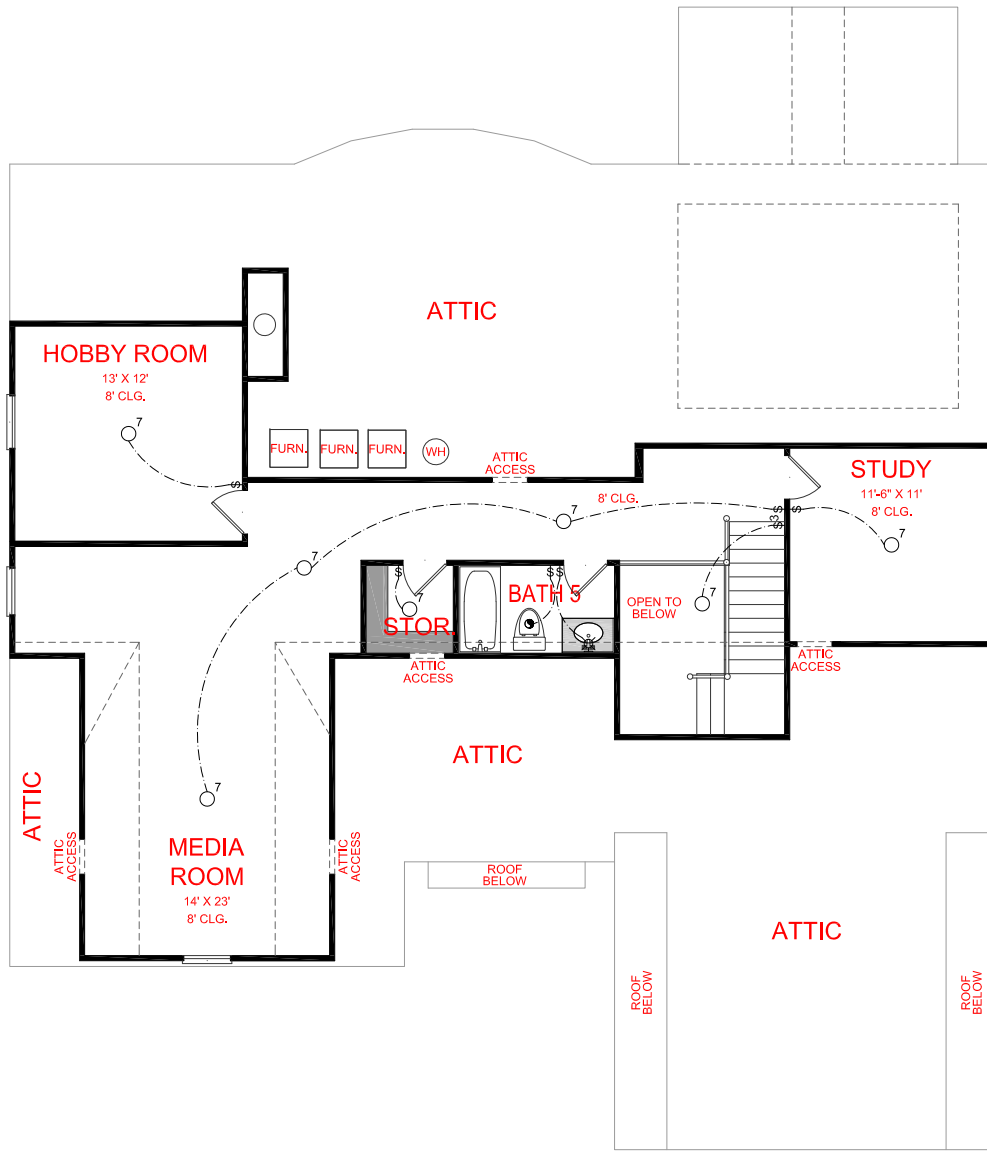

THIRD FLOOR

ELECTRICAL LEGEND	
	CEILING LIGHT FIXTURE
	WALL LIGHT FIXTURE
	7" LED DISK
	10" LED DISK
	CEILING FAN
	FLOOD LIGHT FIXTURE
	DUPLEX FLOOR OUTLET
	TELEPHONE
	NETWORK/CABLE
	SWITCH
	3-WAY SWITCH
	4-WAY SWITCH
	MOTION SENSOR SWITCH
	EXHAUST FAN
	EXHAUST FAN/LIGHT
	SCONCE LIGHT FIXTURE

SQUARE FOOTAGE:	
FIRST FLOOR:	2,124 SQ. FT.
SECOND FLOOR:	2,224 SQ. FT.
THIRD FLOOR:	943 SQ. FT.
TOTAL:	5,291 SQ. FT.

STERLING

JEFF LINDSEY COMMUNITIES
Live your dream.

*THE DRAWING(S) ON THIS PAGE ARE A GRAPHICAL REPRESENTATION ONLY. PLEASE CONSULT YOUR AGENT FOR SPECIFIC INFORMATION REGARDING THIS FLOOR PLAN. THE DESIGN OF THE FLOOR PLAN REPRESENTED IS SUBJECT TO CHANGE WITHOUT NOTICE.